

**SPENCER OFFICE OF
UTILITIES & FACILITIES**

ADDENDUM NO. 3

To: Prospective Bidders and Others

From: William Cundiff, Superintendent, Spencer Utilities & Facilities Office

Date: April 27, 2023

Re: **ADDENDUM NO. 3– Intersection Improvements on Hastings and Wire Village Roads and Widening of Bridge S-23-010 over Turkey Hill Brook in Spencer, MA**

The following information is hereby incorporated into the above referenced bid proposal documents. The Following questions have been submitted by potential bidders.

Question #1:

The elevations shown in the sections on sheet 6 of 12 do not seem to be correct. Please clarify.

Response: *Elevations on sheets 3 and 6 have been corrected. See plan mark up.*

Prepared by:

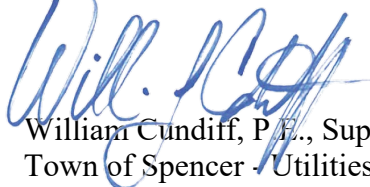

William Cundiff, P.E., Superintendent
Town of Spencer - Utilities and Facilities Office
wcundiff@spencerma.gov

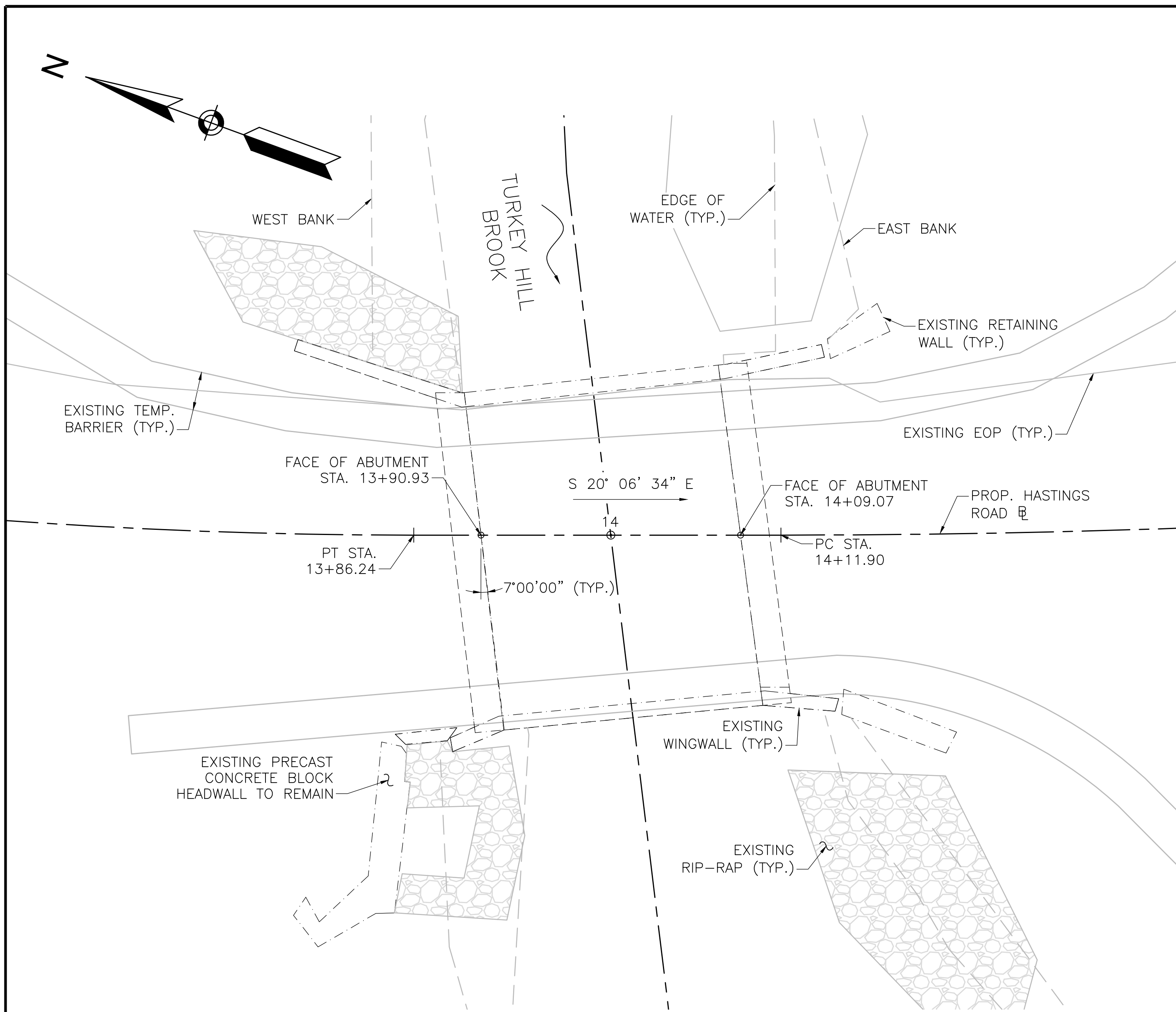

EXISTING GENERAL PLAN
SCALE: $\frac{1}{16}'' = 1'-0''$

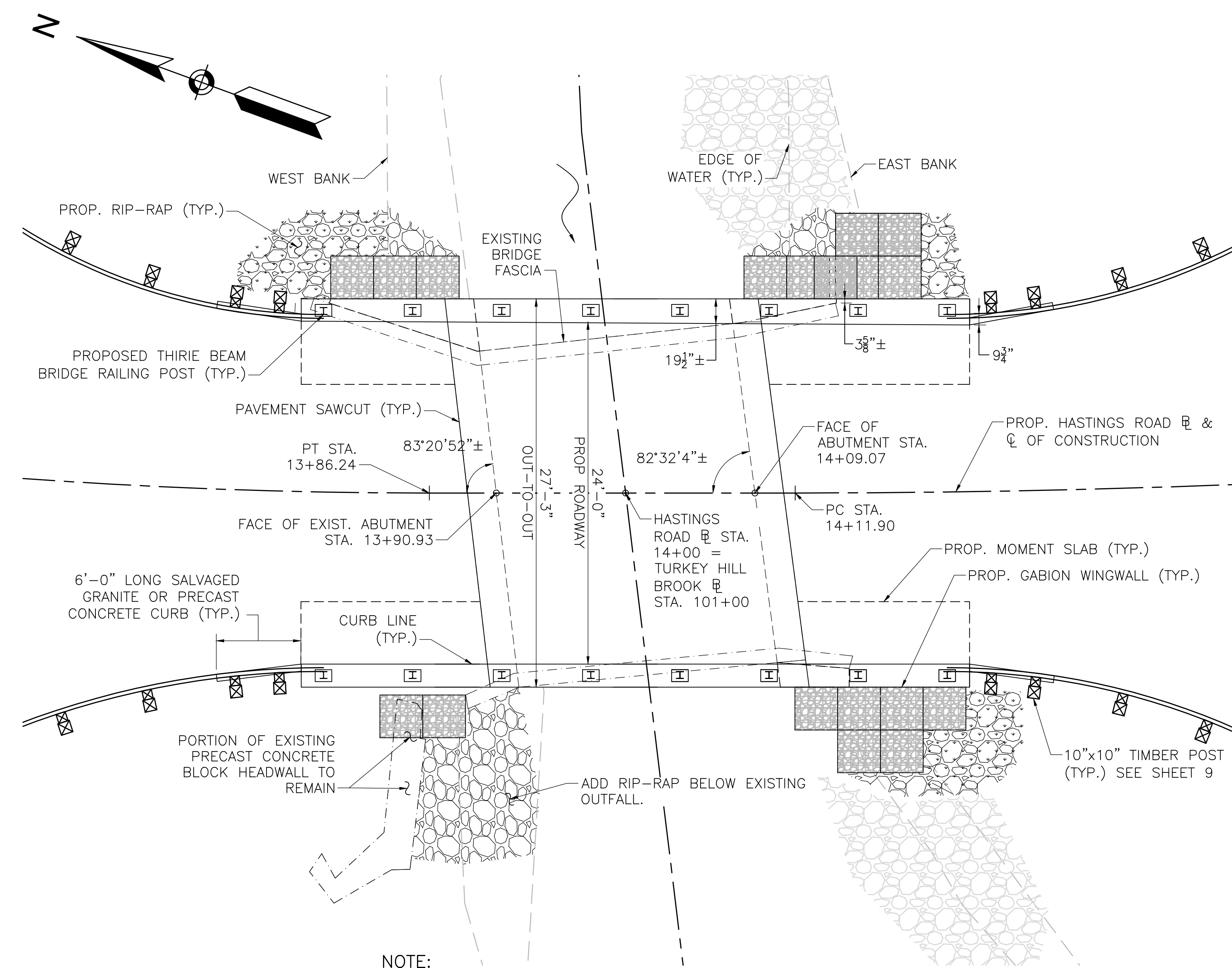

NOTE:
* INDICATES STATION BASED ON ASSUMED ABUTMENT WALL THICKNESS OF 2'-0"
PROPOSED GENERAL PLAN
SCALE: $\frac{1}{16}'' = 1'-0''$

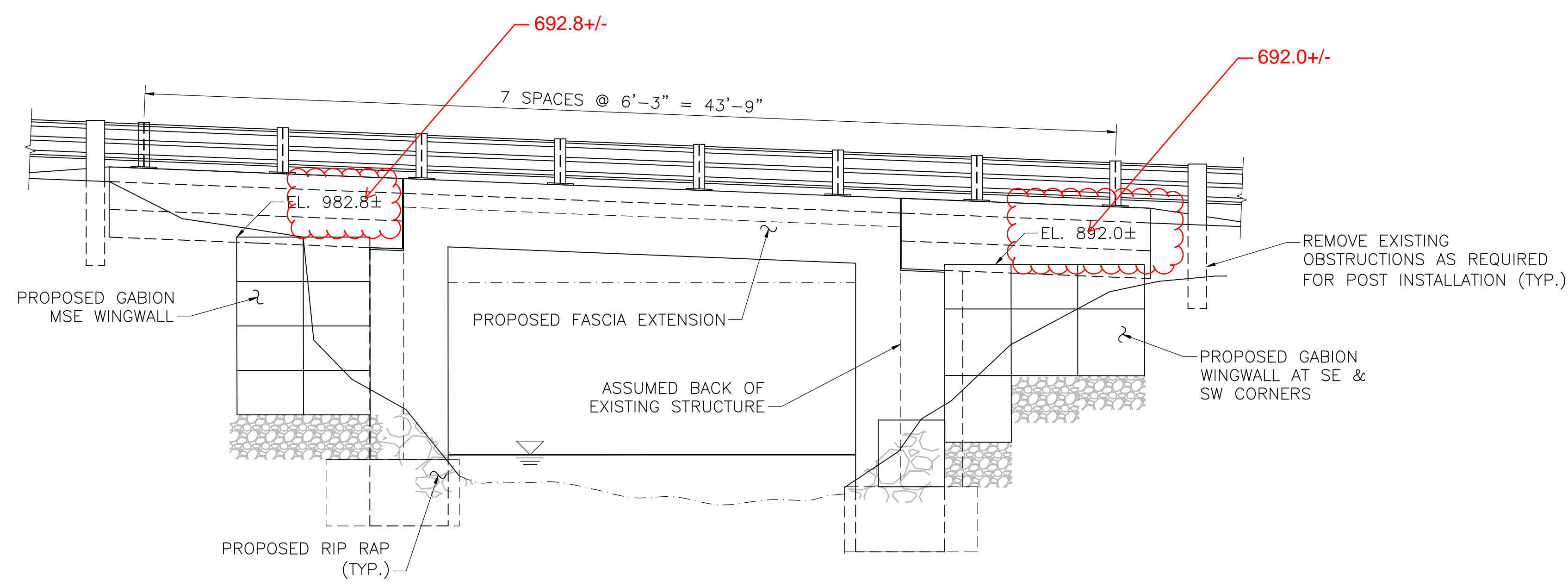

PROPOSED ELEVATION LOOKING EAST
SCALE: $\frac{1}{4}'' = 1'-0''$

COMMONWEALTH OF MASSACHUSETTS
MassDOT, Highway Division
APPROVED UNDER PROVISIONS OF
MASS. GEN. LAWS CH 85 S 35
[Signature]
BRIDGE ENGINEER
8/24/2020
DATE

63 KENDRICK STREET
NEEDHAM, MA 02494
781-355-7100
781-355-7101 (FAX)

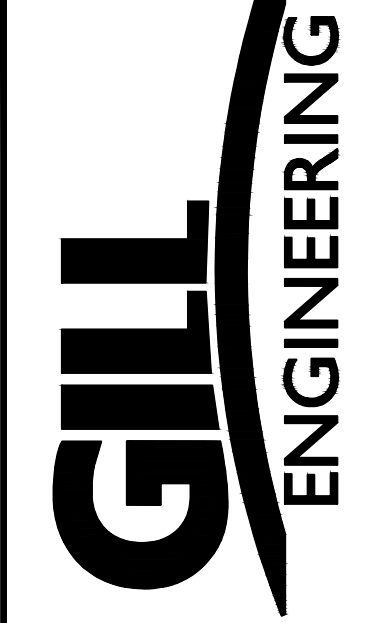

DATE	DRW BY	CALC BY	APPRV. BY	DESCRIPTION
8/24/2020	CM/DOH	CM/DOH	CM/DOH	ISSUE FOR CONSTRUCTION

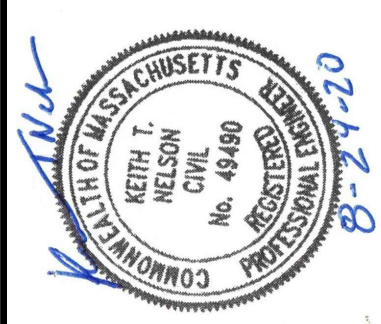

BRIDGE PRESERVATION
TOWN OF SPENCER
BRIDGE PRESERVATION PROJECT FOR
SPENCER S-23-010
HASTINGS RD OVER TURKEY HILL BROOK

GENERAL PLAN & ELEVATION

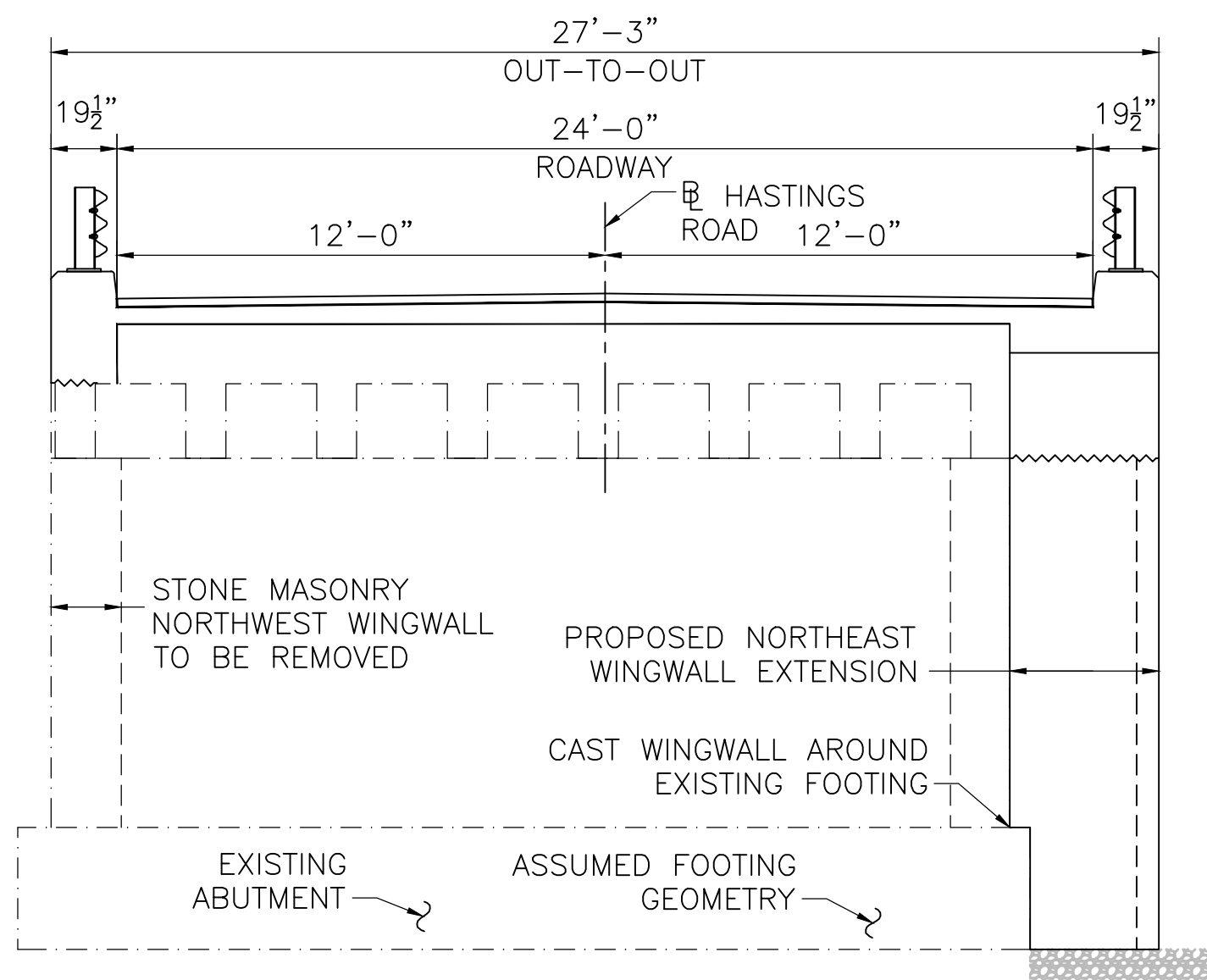

NOTE:
ELEVATION SHOWN SQUARE TO BASELINE.
PROPOSED NORTH ABUTMENT ELEVATION
SCALE: 1/4" = 1'-0"
LOOKING NORTH

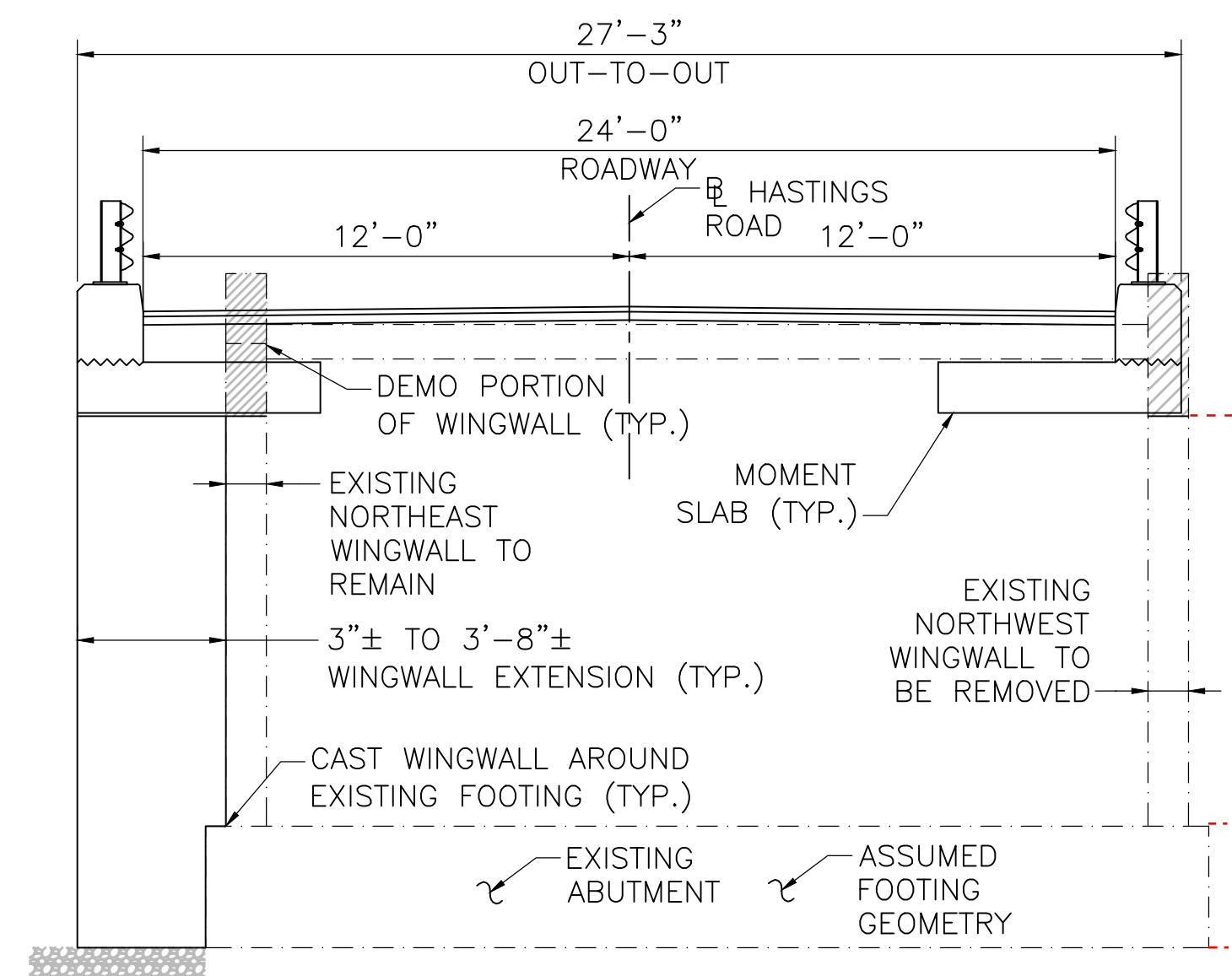

NOTE:
ELEVATION SHOWN SQUARE TO BASELINE.
PROPOSED SECTION BEHIND NORTH ABUTMENT
SCALE: 1/4" = 1'-0"
LOOKING SOUTH

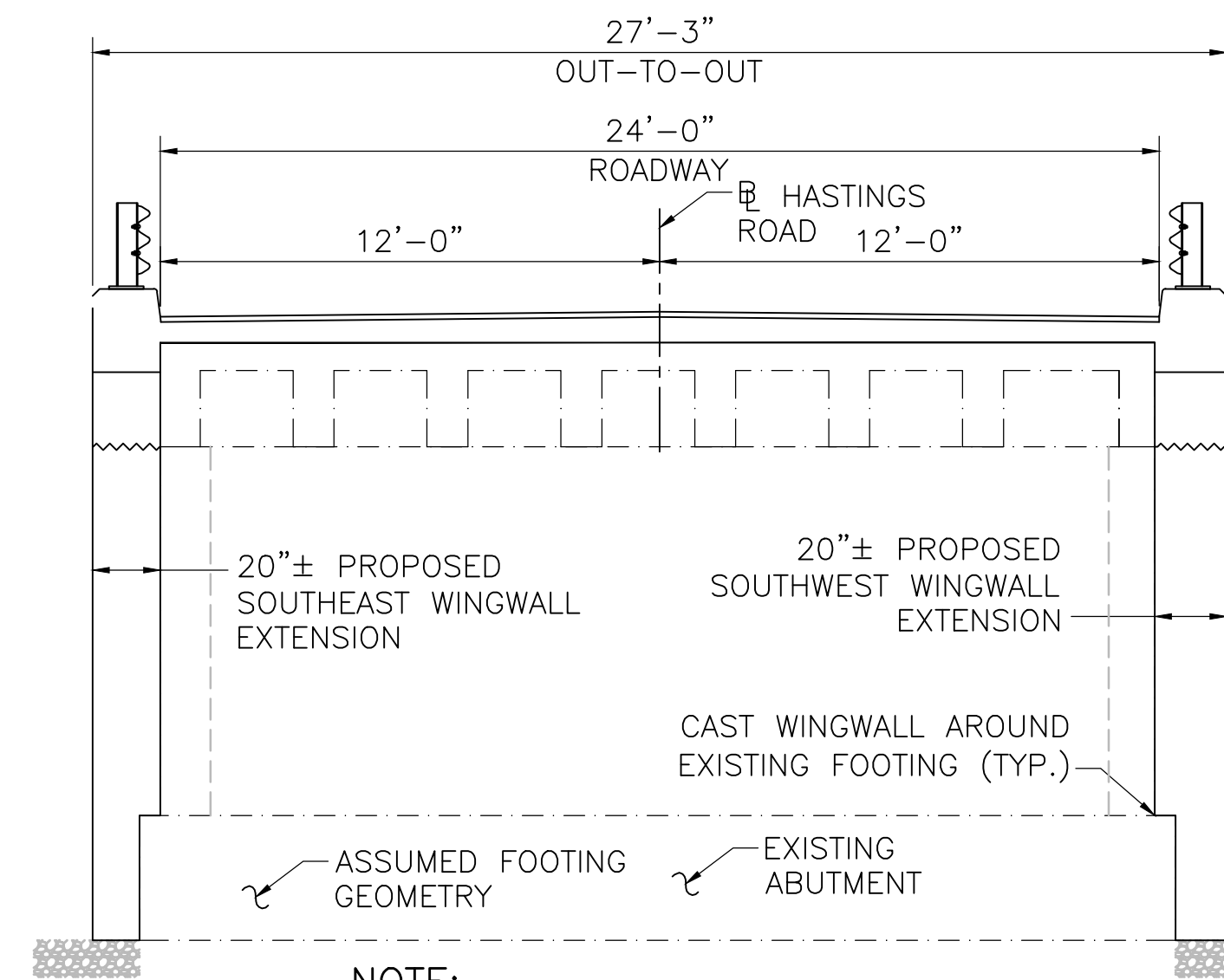

NOTE:
ELEVATION SHOWN SQUARE TO BASELINE.
PROPOSED SOUTH ABUTMENT ELEVATION
SCALE: 1/4" = 1'-0"
LOOKING SOUTH

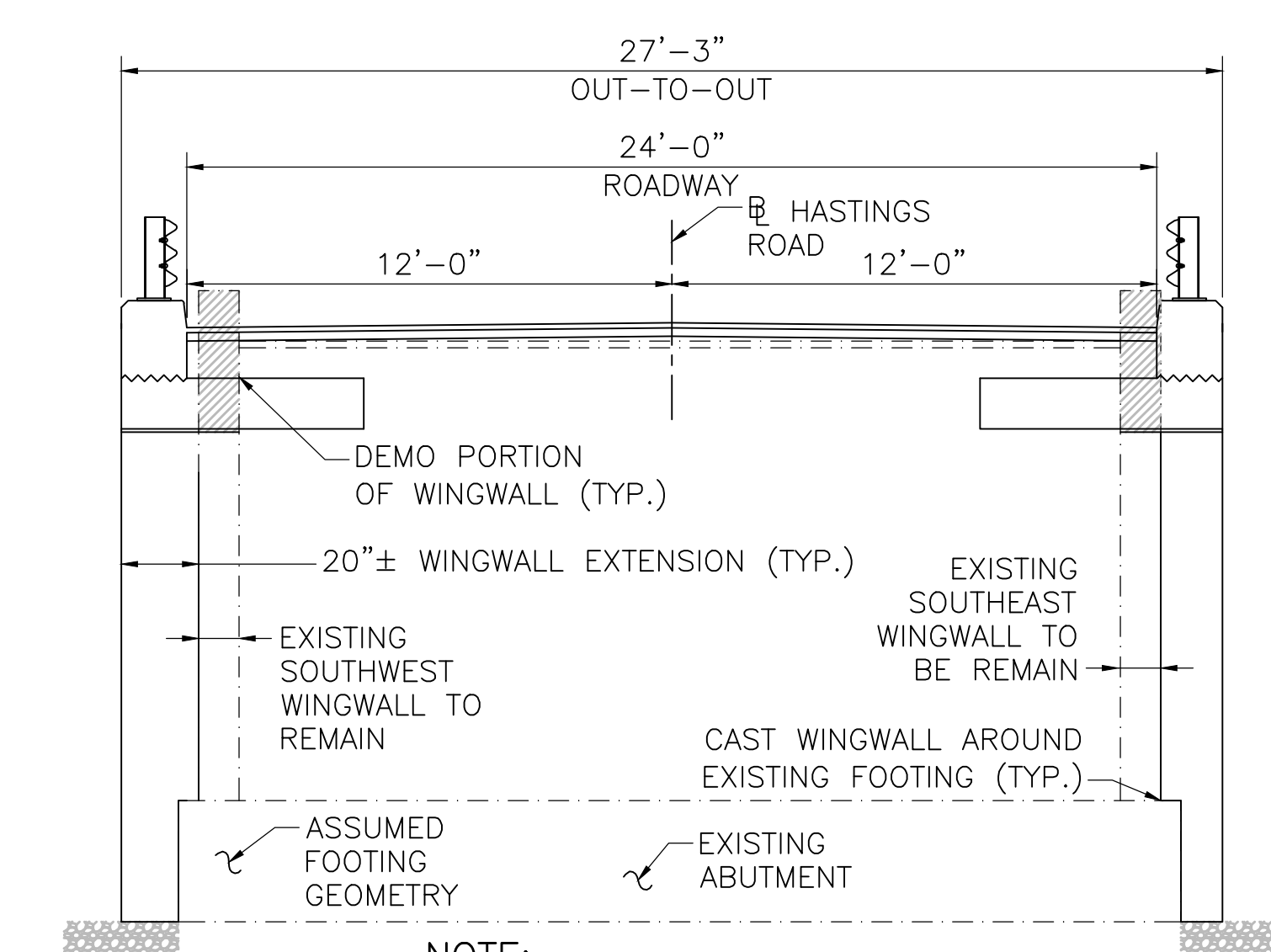

NOTE:
ELEVATION SHOWN SQUARE TO BASELINE.
PROPOSED SECTION BEHIND SOUTH ABUTMENT
SCALE: 1/4" = 1'-0"
LOOKING SOUTH

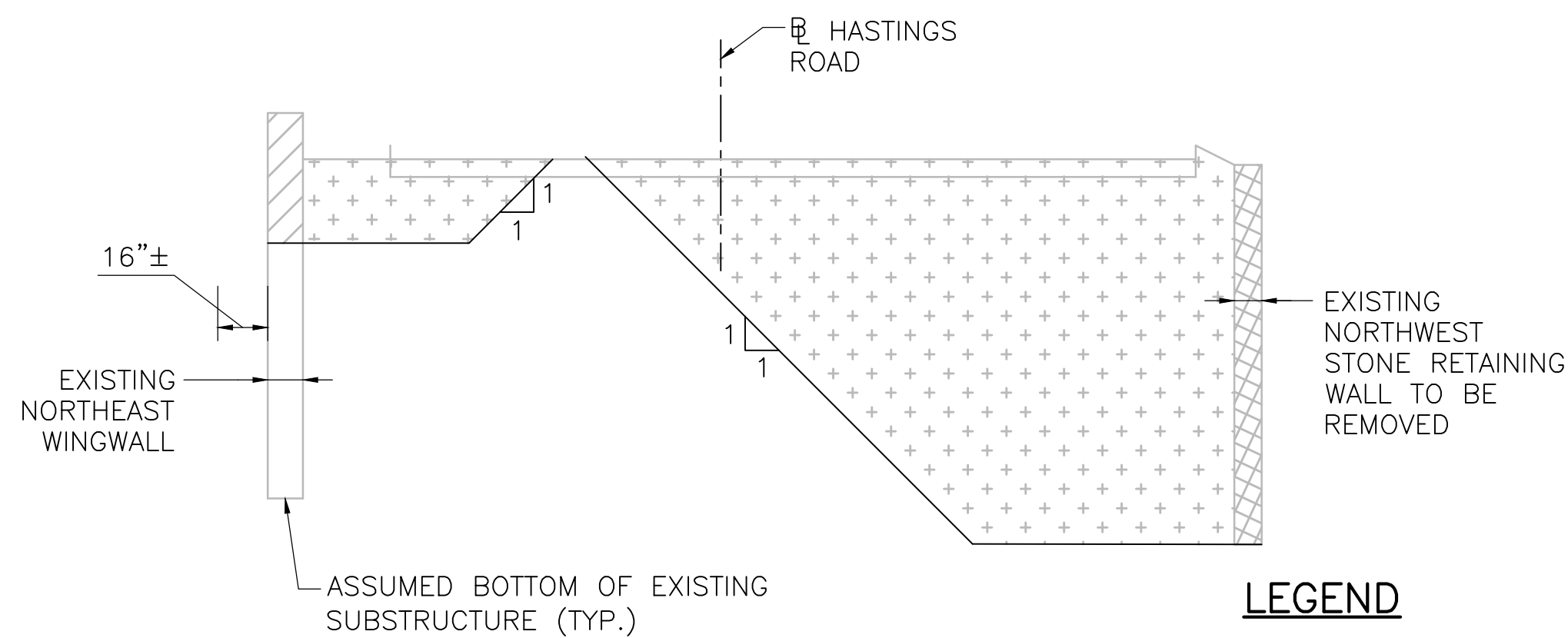

DEMO SECTION @ STA. 13+84.00
SCALE: 1/4" = 1'-0"
(TYPICAL SECTION BETWEEN NORTH WINGWALLS)

- LEGEND**
- BRIDGE EXCAVATION
 - REINFORCED CONCRETE EXCAVATION
 - CLASS B ROCK EXCAVATION

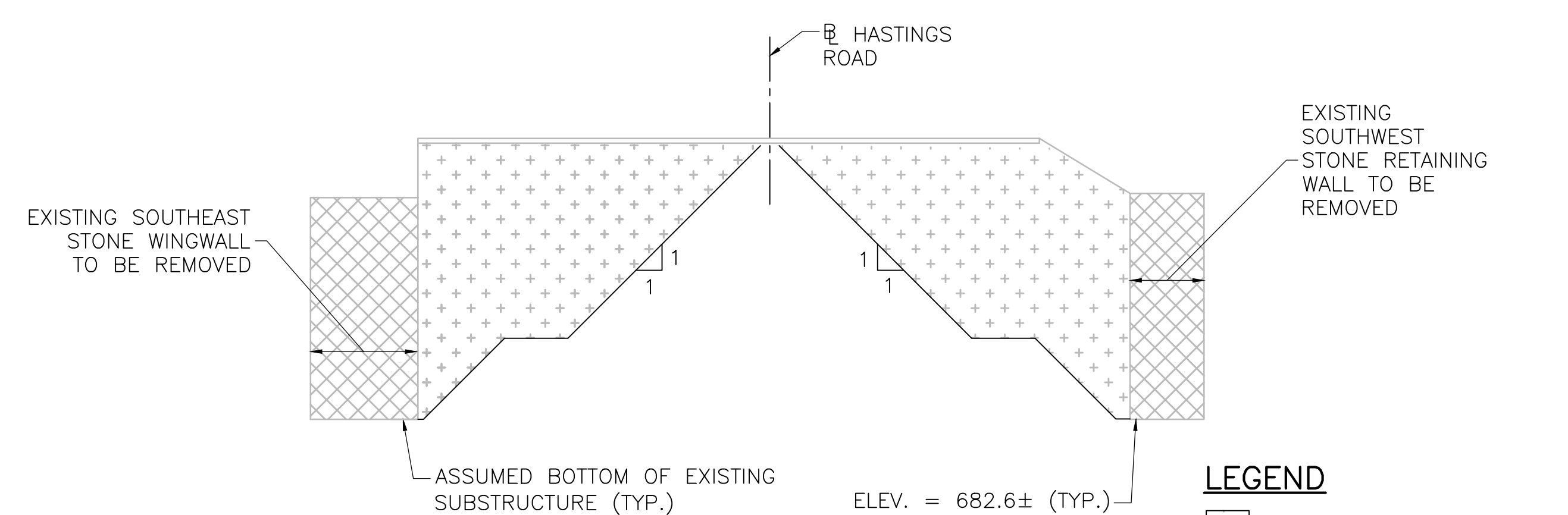

DEMO SECTION @ STA. 14+16.00
SCALE: 1/4" = 1'-0"
(TYPICAL SECTION BETWEEN SOUTH WINGWALLS)

- LEGEND**
- BRIDGE EXCAVATION
 - REINFORCED CONCRETE EXCAVATION
 - CLASS B ROCK EXCAVATION

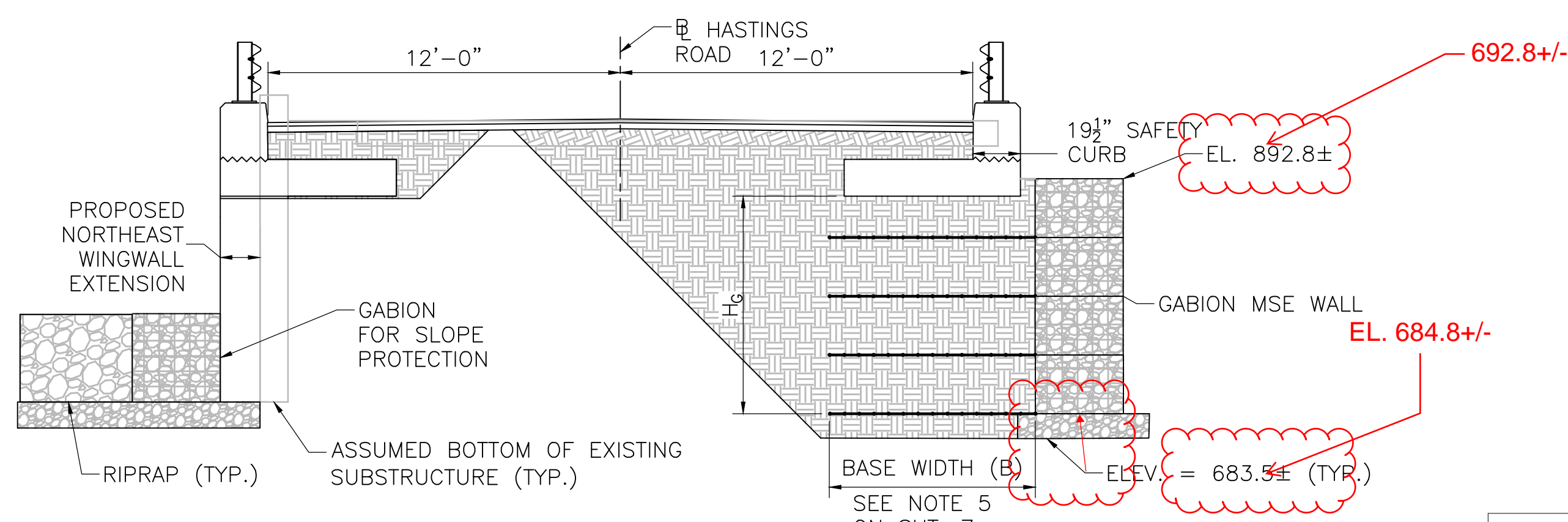

PROPOSED SECTION @ STA. 13+84.00
SCALE: 1/4" = 1'-0"
(TYPICAL SECTION BETWEEN NORTH WINGWALLS)

- LEGEND**
- GRAVEL BORROW TYPE B
 - CRUSHED STONE (SEE SHEET 4)

COMMONWEALTH OF MASSACHUSETTS
MassDOT, Highway Division
APPROVED UNDER PROVISIONS OF
MASS. GEN. LAWS CH 85 S 35
8/24/2020
DATE

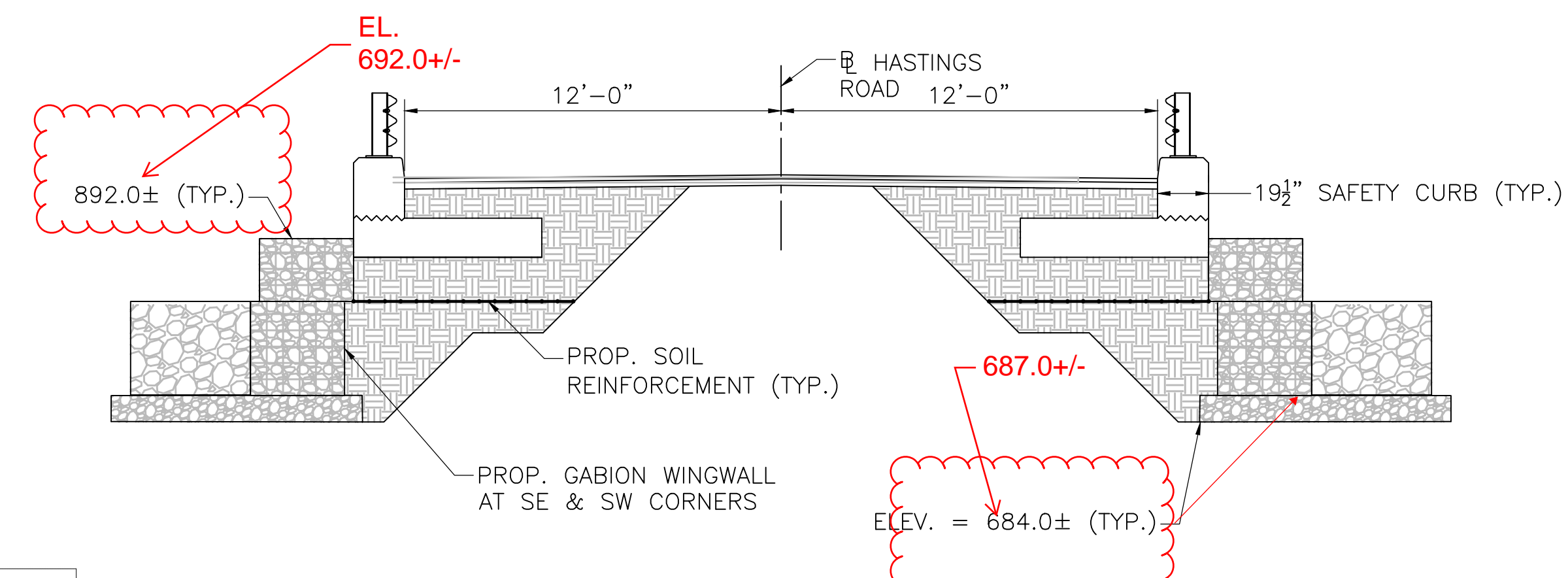

PROPOSED SECTION @ STA. 14+16.00
SCALE: 1/4" = 1'-0"
(TYPICAL SECTION BETWEEN SOUTH WINGWALLS)

- LEGEND**
- GRAVEL BORROW TYPE B
 - CRUSHED STONE (SEE SHEET 4)

DATE	DRW BY	CALC BY	APPRV. BY	DESCRIPTION
8/24/2020	OMW/STH	OMW/STH	KIN	ISSUE FOR CONSTRUCTION

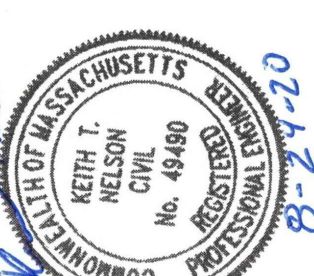

BRIDGE PRESERVATION
TOWN OF SPENCER
BRIDGE PRESERVATION PROJECT FOR
SPENCER S-23-010
HASTINGS RD OVER TURKEY HILL BROOK

ABUTMENT ELEVATIONS